

Datasheet

RS Pro 1.27 Header Socket

RS Stock No: 121-6548

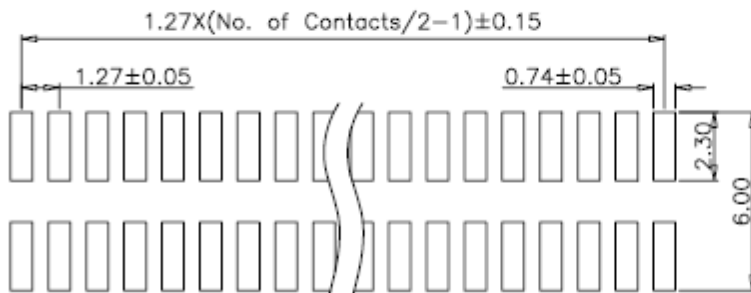
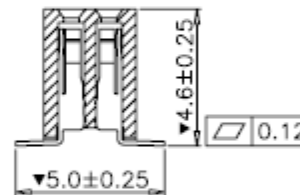
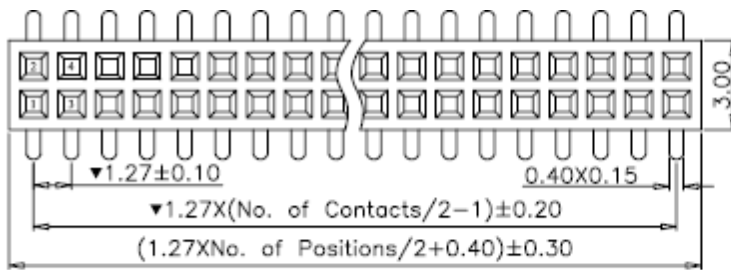

Recommended PCB Board Layout(± 0.1)

Technical Data:

Material

- Contact: Phosphor Bronze, Au Plated over 50μ Nickel
- Insulator: PA6T+30% G.F, Black, UL94V-0, RoHS

Electrical

- Current Rating: 1A/contact max.
- Contact Resistance: $\leq 20\text{m}\Omega$ /contact
- Insulation Resistance: $\geq 1000\text{M}\Omega$ at $V=100\text{V}$
- Withstanding Voltage: 300V AC/minute

Mechanical

- Retention Force: 0.35Kgf/contact min.
- Average Insertion Force: 120g/contact max.
- Average Withdrawal Force: 40g/contact min.
- Mechanical Life Cycle: 200 min.
- Operating Temperature: -55°C to $+105^\circ\text{C}$
- Soldering Temperature: $+260^\circ\text{C}$, 10s max.